

APPLICATION FOR SIGN INSTALLATION NEAR A PRIMARY HIGHWAY GENERAL INSTRUCTIONS

PLEASE NOTE: Application forms must be completed for all proposed signs, including sign information changes within 300 metres of the highway right-of-way boundary or within 800 metres of the centre point of an intersection of the highway with another public road.

Sign construction or changes may not proceed until a permit has been issued by Alberta Infrastructure subject to the provisions of the Public Highways Development Act, Chapter P28 RSA 1995 and the Highway Development Control Regulations (Alberta Regulations 242/96) and amendments thereto.

Complete the application form - please print. Describe the proposed sign and details of its location etc. as requested.

A site plan showing proposed sign set-back and distance from the highway property line to the existing development must be provided. A sign legend diagram showing dimensions of sign face, sign layout showing wording and letter dimensions, sign background colour, etc. must also be provided. If the plan is larger than this page, four copies must be provided. Applicant must sign each copy of the plan.

Types of signs not permitted

1. Any sign that displays an intermittent, flashing or rotating light or lights.
2. Any sign which is flood lighted in such a manner as to cause interference to the motoring public.
3. Any yard lights, area lighting or other lights that, in the opinion of the Operations Manager, are excessively distracting to the public or create a traffic hazard.
4. Any sign that has moving or rotating parts.
5. Any sign that bears a legend giving a command such as a "stop, stop ahead, turn, caution" etc., or any legend that in any way imitates a standard or commonly used traffic signal device or sign.
6. Any sign displaying telephone numbers.
7. Any sign displaying commercial advertising.

Additional Information

1. Reflectorized signs are encouraged in order to provide 24 hour legibility.
2. All signs are to be fabricated professionally using conventional exterior sign materials.
3. Minimum letter size is 15 cm (6 inches). Use of standard letter styles are encouraged for improved legibility.

Return your SIGN APPLICATION to the appropriate Alberta Transportation District Office.

CALGARY	2 nd Floor, 803 Manning Road N.E. T2E 7M8	(403)297-6311
LETHBRIDGE	3 rd Floor, Administration Building, 909 3 rd Avenue N. T1H 0H5	(403)381-5480
RED DEER	#404, 4920 – 51 st Street T4N 6K8	(403)340-5200
HANNA	P.O. Box 1300 Provincial Building 401 Centre Street T0J 1P0	(403)854-5550
VERMILION	Box 28, 4701 – 52 nd Street T9X 1J9	(403)853-8178
ATHABASCA	Unit #2, Jewell Building, 3603 – 53 rd Street T9S 1A9	(780)675-2624
EDSON	2 nd Floor, Provincial Building, 111 – 54 th Street T7E 1T2	(780)723-8250
STONY PLAIN	Room 223, Provincial Building, 4709 – 44 th Avenue T7Z 1N6	(780)963-5711
GRANDE PRAIRIE	1 st Floor, Provincial Building, 10320 – 99 th Street T8V 6J4	(780)538-5310
PEACE RIVER	3 rd Floor, Provincial Bldg, Bag 900, Box 29, 9621 96 Avenue, T8S 1T4	(780)624-6280
FORT MCMURRAY	6 th Floor, West Tower, 9915 Franklin Avenue T9H 2K4	(780)723-7430

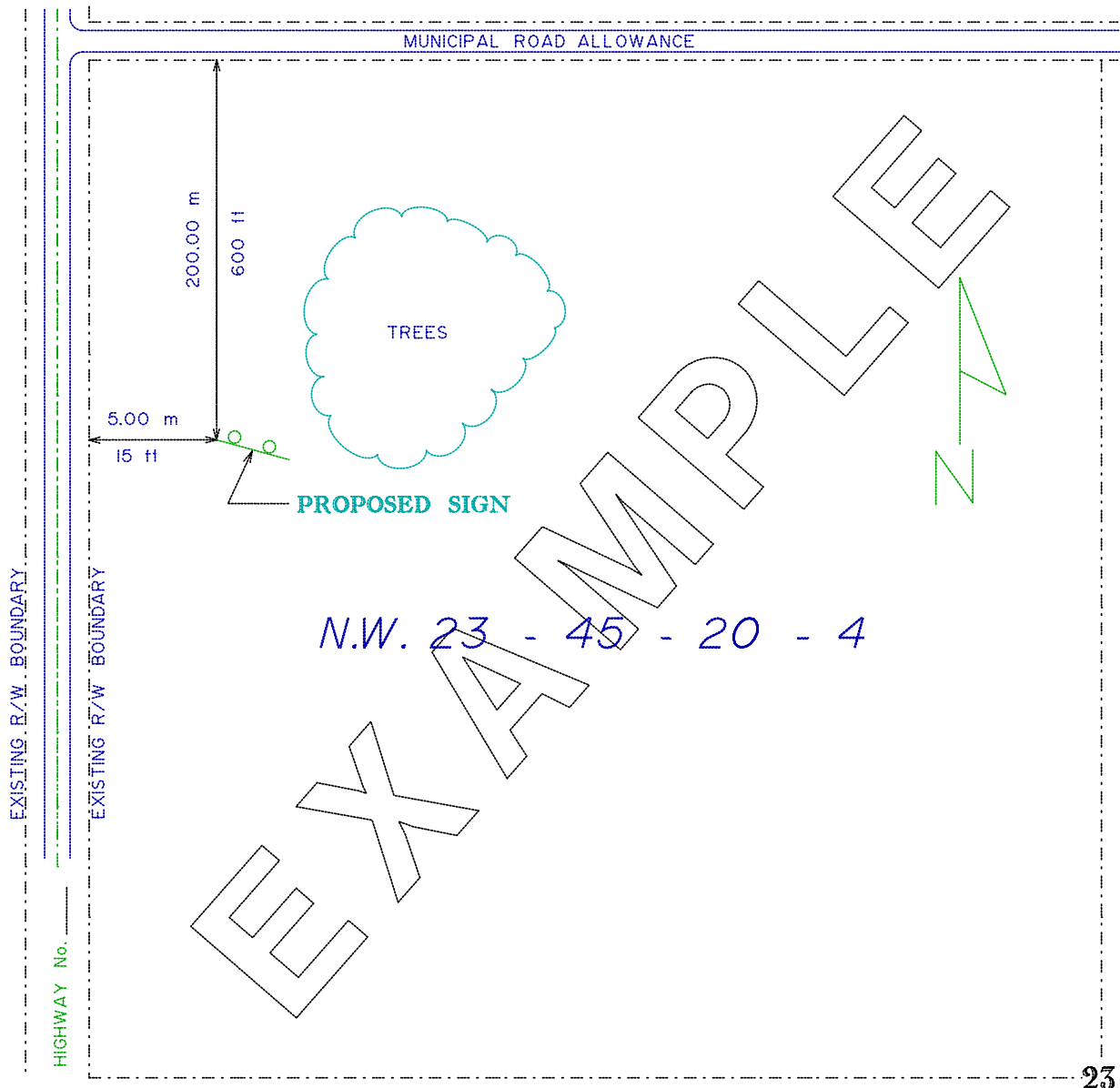

23

SITE PLAN
SKETCH OF PROPOSED SIGN

WHITE BACKGROUND
BLUE LETTERS -----
200 mm HIGH
(8 inches)

1.2 m (4 ft)

2.5 m (8 ft)



Signature of Applicant